

Metal cavity anchor W-MH/L pan head screw

The proven solution for easy and secure fastening in all types of cavity walls. For setting with manual assembly pliers

- Excellent holding power due to spreading supporting elements with large contact radius
- Simple setting with associated mounting pliers
- Pre-assembled with metric pan head screw
- Anti-rotation lock on the collar prevents movement in the drill hole
- Pan head screw can be loosened without loss of holding power

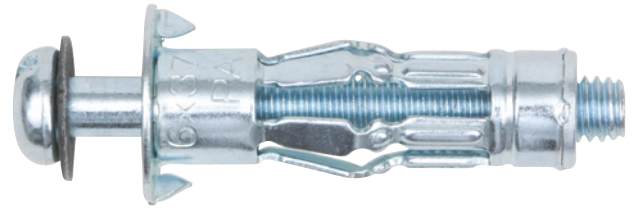

Illustration only

61

| | |
|------------------|---------------------|
| Type description | W-MH/L |
| Design | With pan head screw |
| Material | Steel |
| Surface | Zinc plated |

| Thread type x anchor diameter | Min./max. board thickness/mirror thickness (d a) | Nominal drill-bit diameter (d 0) | Sleeve length (l _{HÜ}) | Screw length | Through-hole in the component to be connected (d f) | Art. no. | P. Qty. |
|-------------------------------|--|----------------------------------|----------------------------------|--------------|---|--------------------|---------|
| M4 | 8-20 mm | 8 mm | 46 mm | 58 mm | 5 mm | 0903 524 46 | 100 |
| M4 | 8-15 mm | 8 mm | 40 mm | 47 mm | 5 mm | 0903 524 40 | 100 |
| M4 | 18-28 mm | 8 mm | 54 mm | 61 mm | 5 mm | 0903 524 54 | 100 |
| M4 | 32-38 mm | 8 mm | 59 mm | 65 mm | 5 mm | 0903 524 59 | 100 |
| M5 | 5-16 mm | 10 mm | 53 mm | 66 mm | 6 mm | 0903 525 53 | 100 |
| M5 | 5-13 mm | 10 mm | 37 mm | 49 mm | 6 mm | 0903 525 37 | 100 |
| M5 | 16-32 mm | 10 mm | 65 mm | 74 mm | 6 mm | 0903 525 65 | 100 |
| M5 | 32-45 mm | 10 mm | 80 mm | 89 mm | 6 mm | 0903 525 80 | 100 |
| M6 | 5-16 mm | 12 mm | 55 mm | 66 mm | 7 mm | 0903 526 55 | 100 |
| M6 | 5-13 mm | 12 mm | 37 mm | 49 mm | 7 mm | 0903 526 37 | 100 |
| M6 | 16-32 mm | 12 mm | 66 mm | 78 mm | 7 mm | 0903 526 66 | 100 |
| M6 | 32-45 mm | 12 mm | 81 mm | 92 mm | 7 mm | 0903 526 81 | 100 |

Performance data

| Anchor diameter [mm] | | M4 | M5 | M6 | |
|---|--------------------------------|------------------------|------|------|------|
| Recommended load ₁ | Plasterboard d ≥ 12 mm | F _{rec.} [kN] | 0,20 | 0,20 | 0,20 |
| | Plasterboard d ≥ 25 mm | F _{rec.} [kN] | 0,30 | 0,30 | 0,30 |
| | Hardboard d ≥ 4 mm | F _{rec.} [kN] | 0,20 | 0,20 | 0,25 |
| | Hardboard d ≥ 10 mm | F _{rec.} [kN] | 0,20 | 0,20 | 0,30 |
| | Particle board d ≥ 10 mm | F _{rec.} [kN] | 0,25 | 0,25 | 0,25 |
| | Hollow ceiling brick d ≥ 30 mm | F _{rec.} [kN] | 0,30 | 0,30 | 0,30 |
| Fire resistance of hollow pumice ² | F90 [in kN] | - | - | 0,12 | |

Characteristic values

| | | | | |
|---------------------------|-----------------------------|-----|------|------|
| ThreadØ | d_{thr} [mm] | M4 | M5 | M6 |
| Nominal drillØ | d_{drl} [mm] | 8,0 | 10,0 | 12,0 |
| HoleØ in component | d_{com} [mm] | 5 | 6 | 7 |

Details/Application

- For secondary attachments in hollow and lightweight construction walls made of panel materials, and in hollow brick ceilings or hollow core ceilings up to a maximum thickness of 45 mm, behind which is a cavity
- For attaching lights, curtain rails, slats and rails, shelves, wall ducts, picture frames, small boilers, consoles, pipe clamps, etc.

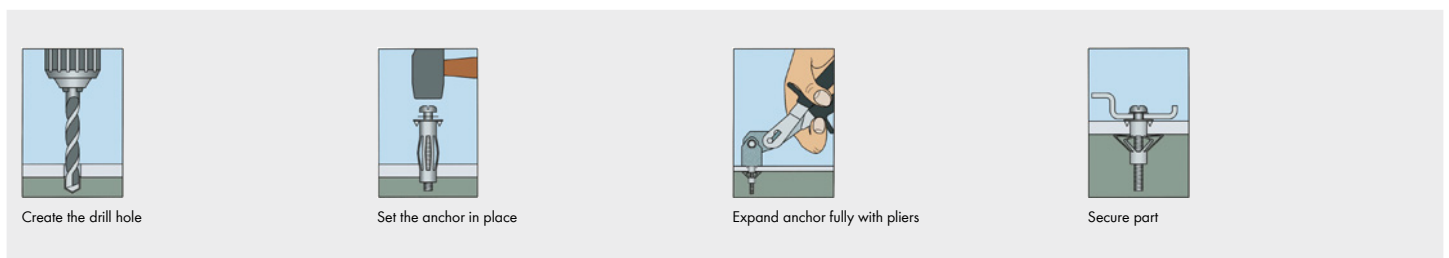
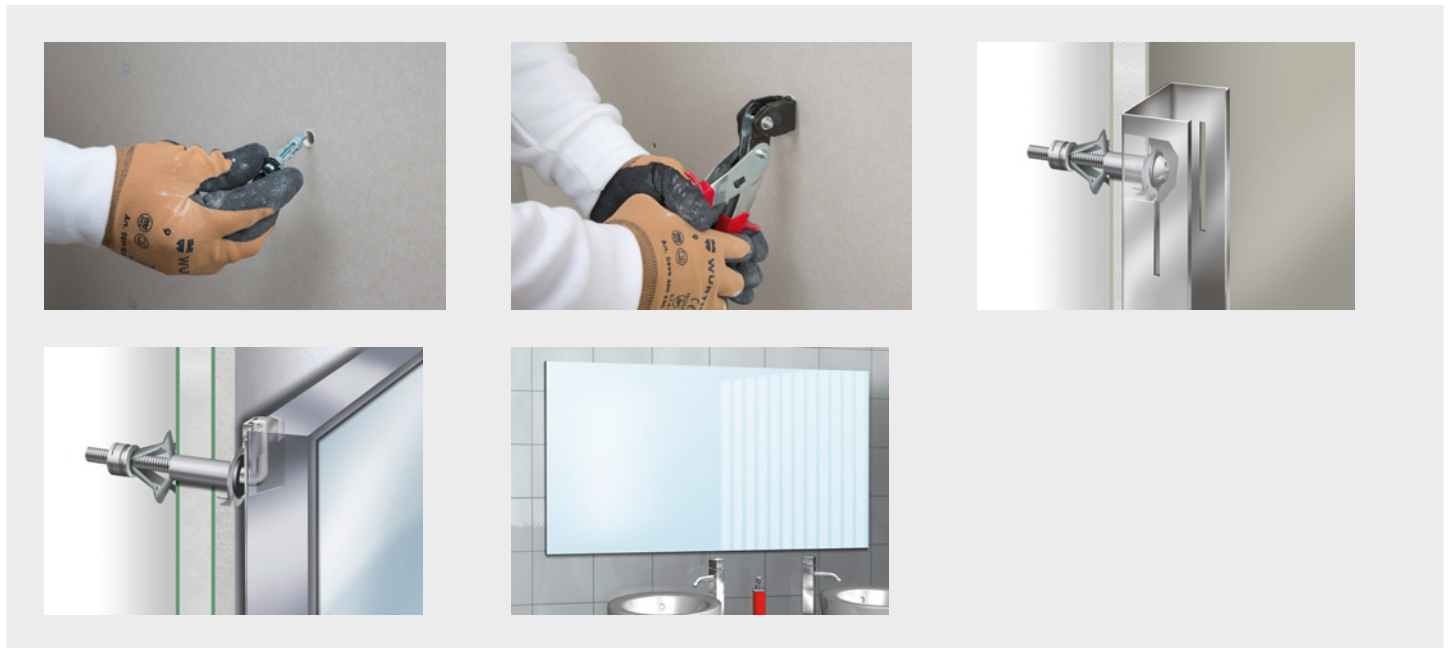

Proof of performance

Fire resistance tested in hollow pumice



Fire resistance

Notice

The standard screw belonging to the anchor can be replaced by another fastening element with a metric thread of the same size after the anchor has been expanded. For example, screw hooks, speciality screws, A2/A4 brass screws, threaded rods, etc.

On hard substrates such as tiles, the lugs on the collar (anti-rotation lock) must be bent straight.

Pushing the front lever on the ratchet pliers releases the ratchet pliers again.

| Related products | Art. no. |
|--|---------------------|
| Manual mounting pliers | 0903 20 |
| Manual mounting pliers | 0903 201 |
| MFD-S multi-purpose drill bit with straight shank 10 mm; Length 120 mm | 0641 201 012 |
| MFD-S multi-purpose drill bit with straight shank 12 mm; Length 150 mm | 0641 201 215 |
| MFD-S multi-purpose drill bit with straight shank 8 mm; Length 120 mm | 0641 208 012 |
| Metal cavity anchor W-MH assortment | 5964 090 300 |